

RADIATORSKI VENTILI  
RADIATOR VALVES  
HEIZKÖRPERVENTILE

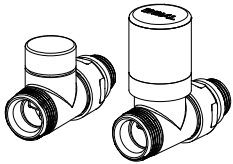

SL  
Radiatorski ventili, kotni ali ravni priklp. Thermostatska ali ročna regulacija. Za priključitev na bakreno, plastično ali jekleno cev.  
**Tehnične karakteristike**  
Max. statični delovni tlak: 10 bar  
Max. delovna temperatura: 110 °C  
Max. diferencialni tlak: 1 bar

EN  
Valves for radiators, angled or straight form. Thermostatic and manual models. Connections for copper, plastic or iron pipe.

**Operating features**  
Max static operating pressure : 10 bar  
Max operating temperature : 110°C  
Max differential pressure : 1 bar

DE  
Heizkörperventile, gerade oder Eckform. Thermostat und manuelles Modell. Anschluß für Kupfer-, Kunststoff- oder Eisenrohr.

**Technische Merkmale**  
Max statischer Arbeitsdruck : 10 bar  
Max Temperatur : 110°C  
Max Differenzdruck : 1 bar

VGRADNJA  
INSTALLATIONS  
INSTALLATION

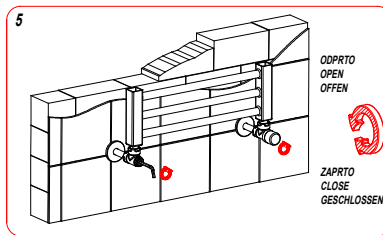
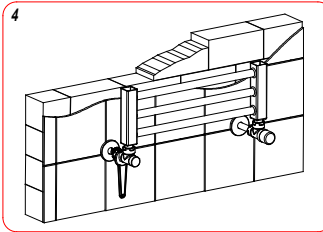
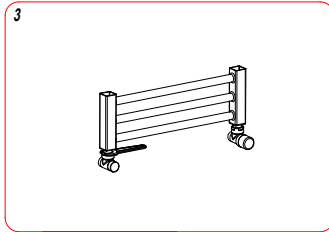
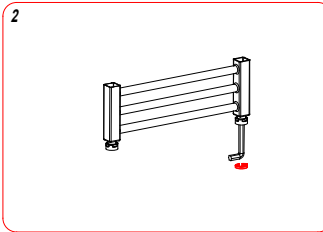
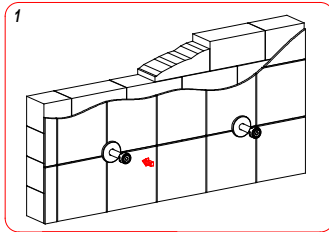

TERMOSTATSKA GLAVA  
THERMOSTATIC HEAD  
THERMOSTATKOPF

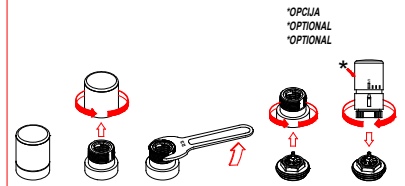

PREDNASTAVITEV  
PRESETTING  
VOREINSTELLUNG

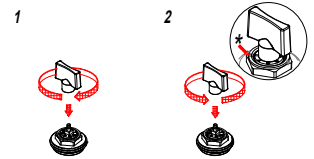

1. Zaprite prednastavljeno zapiralo / Close presetting ring nut / Den voreingestellten Ring schließen;
2. Odprite zapiralo in ga ponastavite na eno izmed številik (\*) / Open the ring and make the index coincide with one of the numbers (\*) / Öffnen Sie den Ring, um den Index mit einer der Nummern abzustimmen (\*);

RADIATORSKI VENTILI  
RADIATOR VALVES  
HEIZKÖRPERVENTILE

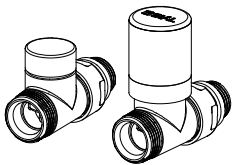

SL  
Radiatorski ventili, kotni ali ravni priklp. Thermostatska ali ročna regulacija. Za priključitev na bakreno, plastično ali jekleno cev.  
**Tehnične karakteristike**  
Max. statični delovni tlak: 10 bar  
Max. delovna temperatura: 110 °C  
Max. diferencialni tlak: 1 bar

EN  
Valves for radiators, angled or straight form. Thermostatic and manual models. Connections for copper, plastic or iron pipe.

**Operating features**  
Max static operating pressure : 10 bar  
Max operating temperature : 110°C  
Max differential pressure : 1 bar

DE  
Heizkörperventile, gerade oder Eckform. Thermostat und manuelles Modell. Anschluß für Kupfer-, Kunststoff- oder Eisenrohr.

**Technische Merkmale**  
Max statischer Arbeitsdruck : 10 bar  
Max Temperatur : 110°C  
Max Differenzdruck : 1 bar

VGRADNJA  
INSTALLATIONS  
INSTALLATION

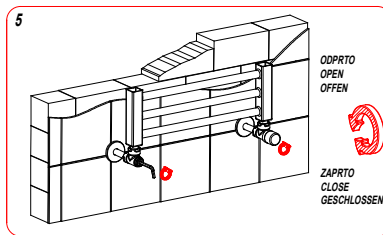
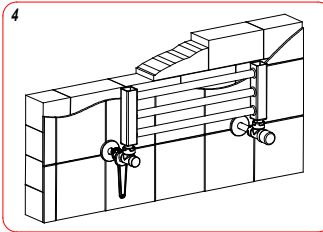
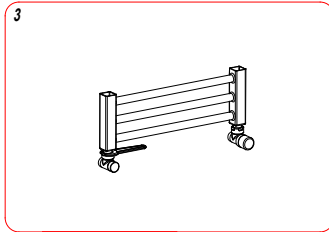
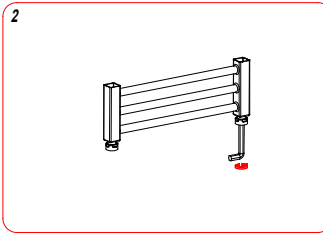
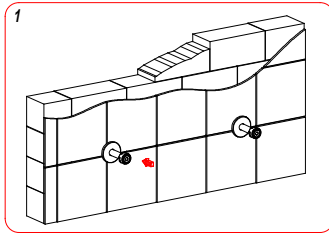

TERMOSTATSKA GLAVA  
THERMOSTATIC HEAD  
THERMOSTATKOPF

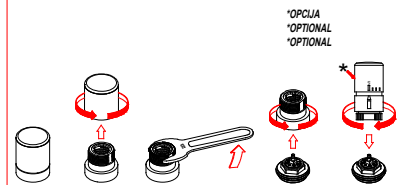

PREDNASTAVITEV  
PRESETTING  
VOREINSTELLUNG

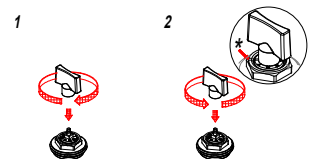

1. Zaprite prednastavljeno zapiralo / Close presetting ring nut / Den voreingestellten Ring schließen;
2. Odprite zapiralo in ga ponastavite na eno izmed številik (\*) / Open the ring and make the index coincide with one of the numbers (\*) / Öffnen Sie den Ring, um den Index mit einer der Nummern abzustimmen (\*);

TERMOSTATSKI VENTIL  
THERMOSTATIC VALVE  
THERMOSTATISCHES VENTIL

ZAPIRALO  
LOCKSHIELD VALVE  
DETENTOR

DN 15 1/2"

DN 15 1/2"

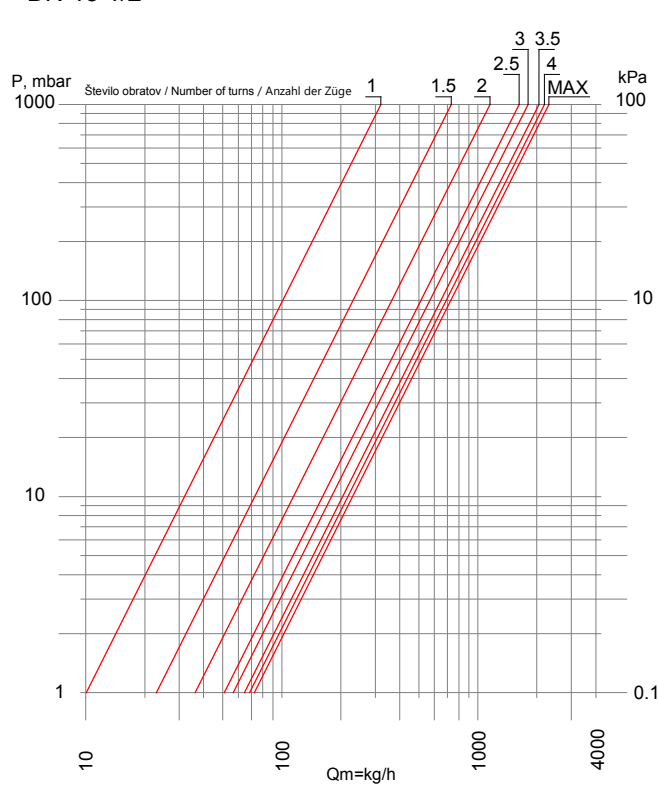
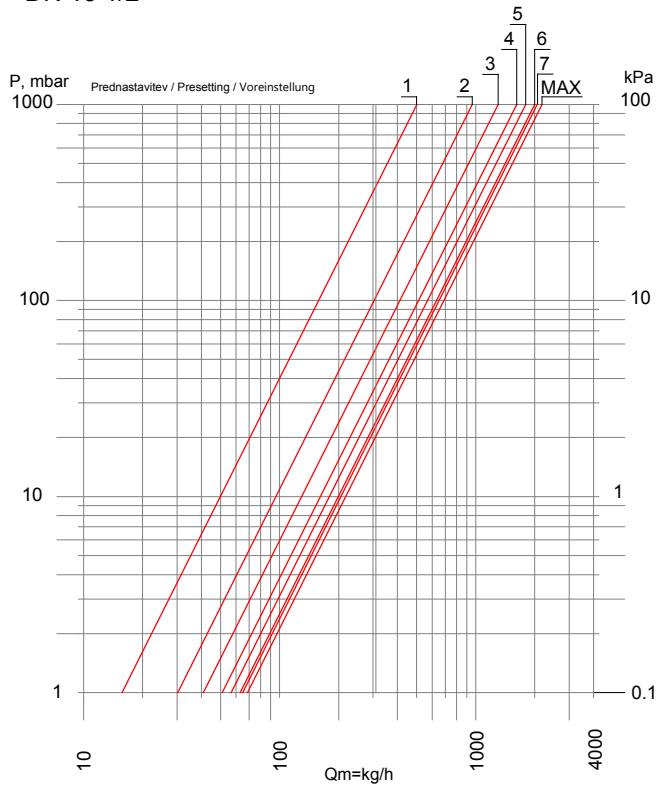

	1	2	3	4	5	6	7	MAX
KV	0.50	0.96	1.30	1.62	1.80	2.00	2.06	2.18

	1	1.5	2	2.5	3	3.5	4	MAX
KV	0.32	0.73	1.15	1.62	1.80	2.05	2.18	2.30

TERMOSTATSKI VENTIL  
THERMOSTATIC VALVE  
THERMOSTATISCHES VENTIL

ZAPIRALO  
LOCKSHIELD VALVE  
DETENTOR

DN 15 1/2"

DN 15 1/2"

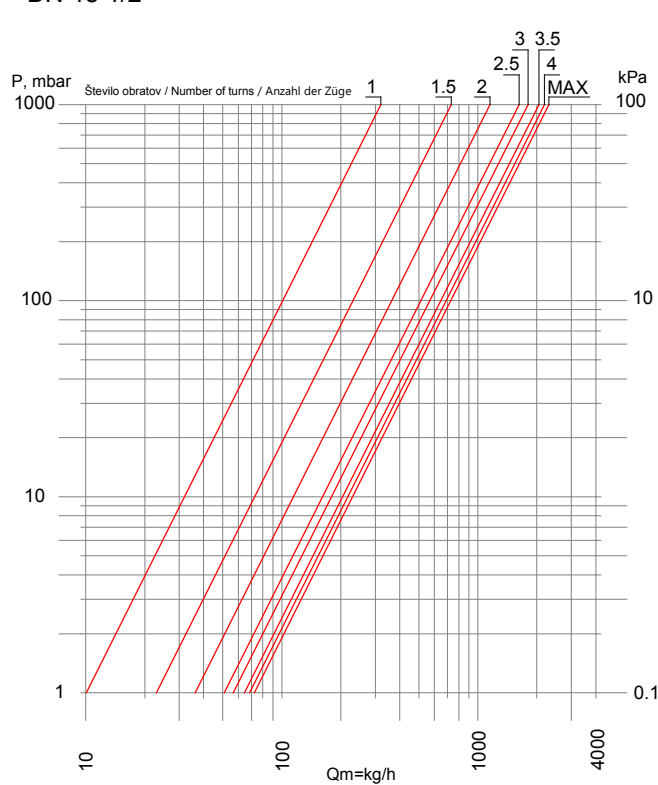
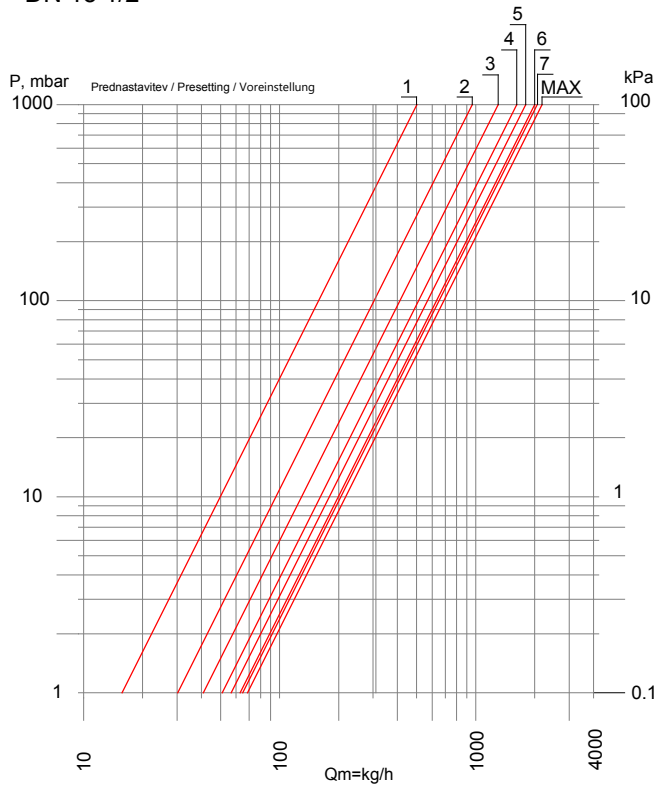

	1	2	3	4	5	6	7	MAX
KV	0.50	0.96	1.30	1.62	1.80	2.00	2.06	2.18

	1	1.5	2	2.5	3	3.5	4	MAX
KV	0.32	0.73	1.15	1.62	1.80	2.05	2.18	2.30